



**Release Date:** 2024/02/26

**Version:** 5.1.2

**Downtime Expected:** None

## **Virtual IPM Release Notes**

### **Updates included in this release:**

#### **New Features:**

1. Highlight Required Fields in Patient Workflow

#### **Bug Fixes:**

1. Fix for Replacement Text for a DLS Objective
2. Fix for Email Field Label - Patient Record
3. Adjust Patient Service Query
4. Fix for Email Field Label - "Send Reminder" workflow
5. Fix for Sorting Questionnaires in Patient Portal



## **Feature #1 Highlight Required Fields in Patient Workflow**

Details:

1. Implemented logic to make required field stand out in the patient workflow, in order to ensure required fields are not missed, leading to confusion on the patient's side

A screenshot of a web application interface for a patient assessment platform. At the top left is the "Quadrant Biosciences" logo. At the top right, it says "PATIENT ASSESSMENT PLATFORM" with a "Help" icon. Below this is a header for "Parent Survey" with a "Questionnaire 1" tab. To the right of the header is a "Survey Progress" indicator showing "Step 1 of 4". The main content area contains a question: "Who is completing the forms for the patient? (required)". Below the question is a dropdown menu with the text "Select an option" and a downward arrow. A yellow warning banner with a triangle icon contains the text: "All required fields must be complete and valid to continue. Please review the form for missing or invalid responses." At the bottom of the form are three buttons: "Cancel", "Save & Quit", and "Next".

1) Tends to forget certain expected tasks. (required)

Never  Rarely  Sometimes  Often  Very Often

2) Has trouble keeping things organized. (required)

Never  Rarely  Sometimes  Often  Very Often

3) Tends to lose things. (required)

Never  Rarely  Sometimes  Often  Very Often

4) Has difficulty staying on task. (required)

Never  Rarely  Sometimes  Often  Very Often

5) Has trouble keeping things at the back of their mind when doing something else. (required)

Never  Rarely  Sometimes  Often  Very Often

6) Is easily distracted. (required)

Never  Rarely  Sometimes  Often  Very Often

7) Moves from one activity to another without completing anything. (required)

Never  Rarely  Sometimes  Often  Very Often

8) Has difficulty starting tasks and activities. (required)

Never  Rarely  Sometimes  Often  Very Often

 All required fields must be complete and valid to continue. Please review the form for missing or invalid responses.

[Previous](#) [Save & Quit](#) [Next](#)

### **Fix #1 Fix for Replacement Text for a DLS Objective**

Details:

1. Addressed a bug for a DLS objective - the replacement text in the code needed to be updated so the front end was able to find the area of text in the objective which needed to be replaceable

### **Fix #2 Fix for Email Field Label - Patient Record**

Details:

1. Updated the label for the “parent/caregiver” field
2. This was updated to the following: “Parent/Caregiver Email Address”

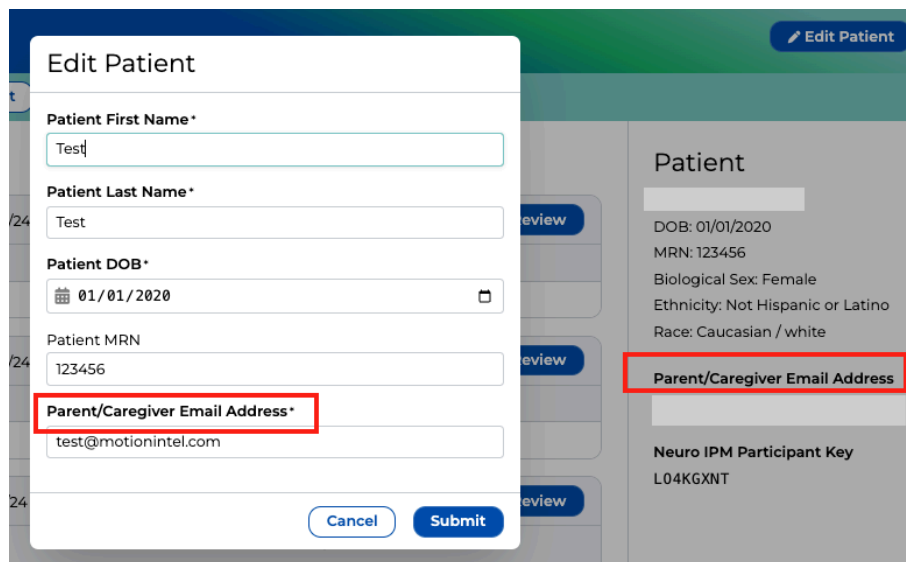
A screenshot of a web application interface. A modal window titled "Edit Patient" is open, displaying several input fields. The fields are: "Patient First Name\*" with the value "Test"; "Patient Last Name\*" with the value "Test"; "Patient DOB\*" with a date picker set to "01/01/2020"; "Patient MRN" with the value "123456"; and "Parent/Caregiver Email Address\*" with the value "test@motionintel.com". The label for the email field is highlighted with a red box. In the background, a "Patient" record is visible, with the label "Parent/Caregiver Email Address" also highlighted with a red box. The record includes fields for "DOB: 01/01/2020", "MRN: 123456", "Biological Sex: Female", "Ethnicity: Not Hispanic or Latino", "Race: Caucasian / white", and "Neuro IPM Participant Key: L04KGXNT".

### **Fix #3 Adjust Patient Service Query**

Details:

1. Updated the query in patient service to align “completed” and “completed\_date”
2. This will address a bug where the date displayed in the “Assessment Status” column on the patient landing page was incorrect

### **Fix #4 Fix for Email Field Label - “Send Reminder” workflow**

Details:

1. Updated the label for the email field in the “send reminder” workflow
2. This was updated to the following: “Delivery Address”

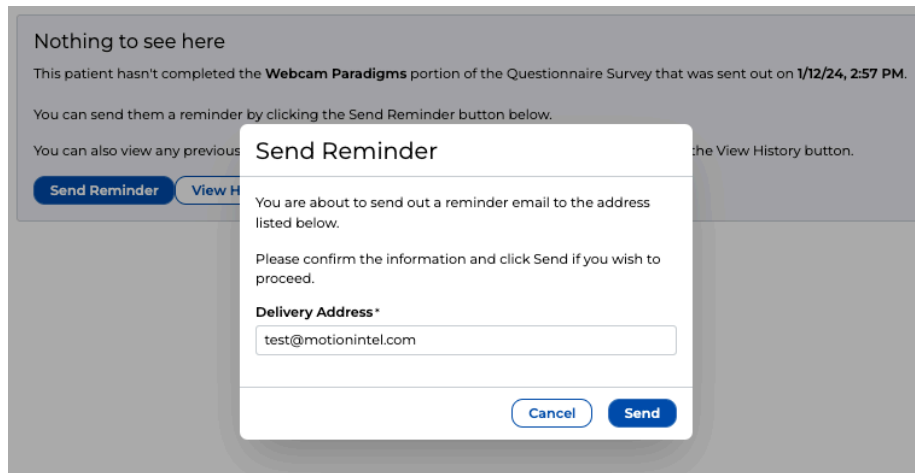

### **Fix #5 Fix for Sorting Questionnaires in Patient Portal**

#### Details:

- Fixed a bug where the questionnaires were getting sorted incorrectly in the patient workflow if the page was refreshed
- This caused the user to be routed to the **landing page** and they were unable to re-enter the workflow to completed the remaining assessment(s)